



Nebraska Public Power District

Always there when you need us

April 2014

R-Project 345,000 Volt



Transmission Line PROJECT

Transmission line route options, substation site areas to highlight upcoming open houses

Nebraska Public Power District will host a third round of open houses in late April/early May for the R-Project. The R-Project consists of routing and siting a new electric transmission line that will run from NPPD's Gerald Gentleman Station near Sutherland north to a new substation to be sited adjacent to NPPD's existing substation east of Thedford. The new line will then proceed east and connect to a second substation to be sited near the existing Western Area Power Administration (WAPA) 345,000 volt transmission line in the Holt/Antelope/Wheeler County area. No final line routes have been determined at this time.

This project is needed to enhance transmission system reliability, relieve congestion from existing lines, and provide opportunities for additional renewable energy generation.

NPPD is now ready to begin the third of four steps in its public involvement process. In the first step, the District hosted open houses at six different locations within the study area to provide a project overview and share the study area with the public. The project team reviewed public comments received during the first open house to narrow the study area to corridors. Those corridors were shared with the public last September at NPPD's second round of open houses. After a review of information following the first two rounds of open houses and further analysis of the transmission system operational needs, performance and costs, Thedford was identified as the best location for the first of the two substation sites to be constructed.

Following determination of the Thedford substation site, the project team continued to review the information

gathered from the first two rounds of open houses and identified several potential line routes and substation sites near WAPA's 345,000 volt transmission line (see inside pages). Pending additional public input and the final public hearing, all alternatives are viable options. Please note that the western north-south corridor does not have any line routes that will be carried forward. Routes through the western corridor were thoroughly evaluated and considered but eliminated due to many factors, including accessibility.

The project team devoted numerous hours to the line routing process, as well as reviewing public comments. "The team evaluated more than 19,000 options totaling more than 9,000 miles," said Senior Project Manager **Craig Holthe**. "This included reviewing nearly 1,770 comments received from the public and various agencies involved with the project."

"The preferred route largely follows Highway 83 from Gentleman Station to Thedford," continued Holthe. "From Thedford it then utilizes the northern east-west corridor that generally parallels the county lines over to the WAPA line."

"At this time, NPPD is pursuing the use of single pole structures with concrete foundations in easily accessible areas, such as along roads," Holthe said. "Lattice steel structures appear to be the best structure type in areas of challenging accessibility, where screw-in anchor type foundations can be used rather than concrete, resulting in less traffic impact to the property. Lattice structures may also reduce the need for heavy trucks during future maintenance activities."

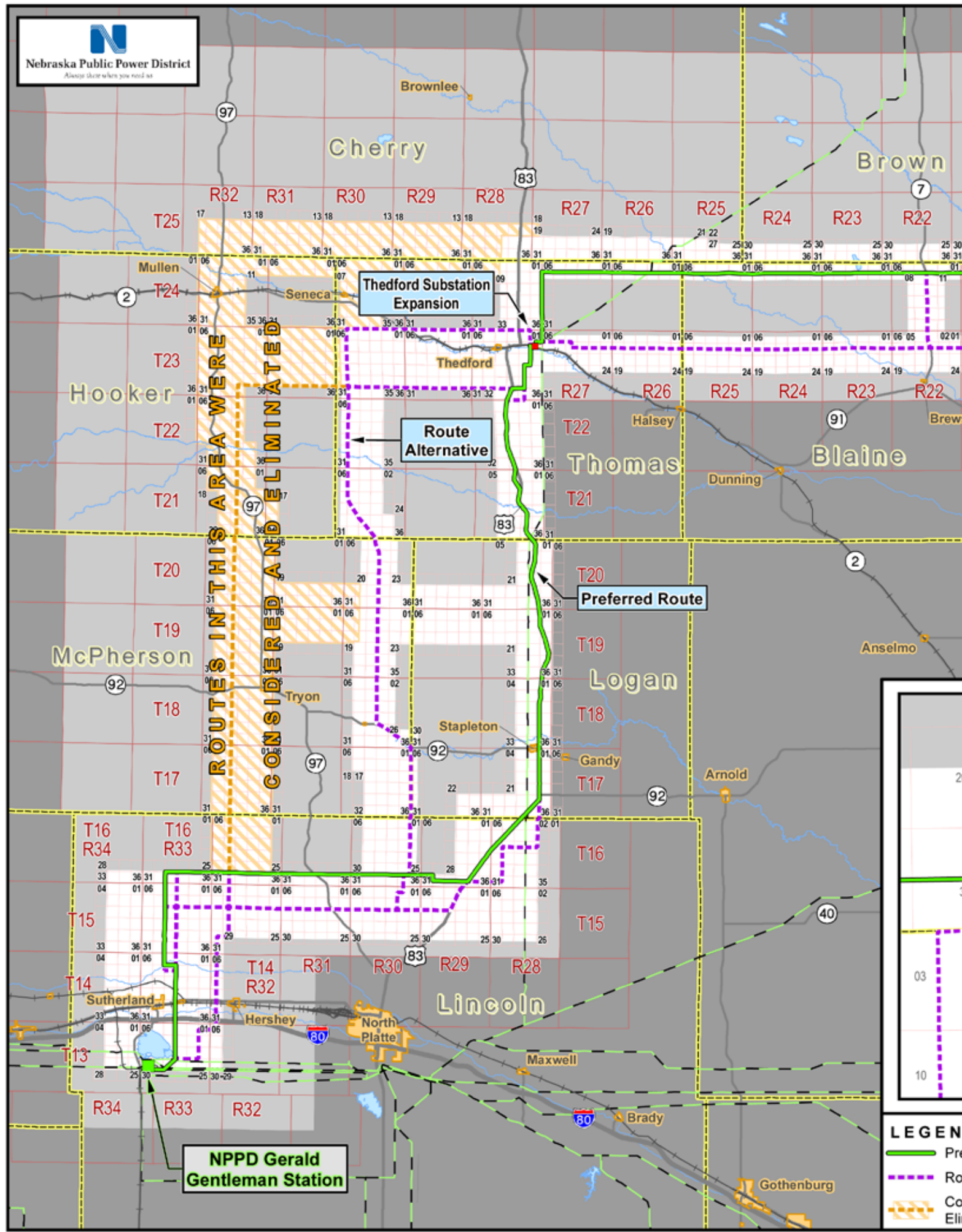

ROUTES IN THIS AREA WERE CONSIDERED AND ELIMINATED

Theford Substation Expansion

Route Alternative

Preferred Route

NPPD Gerald Gentleman Station

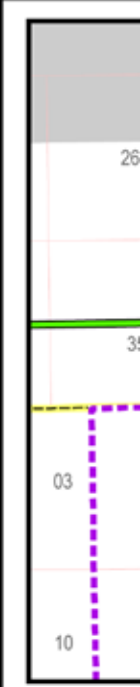

LEGEND

- Preferred Route
- - - Route Alternative
- Routes Considered and Eliminated

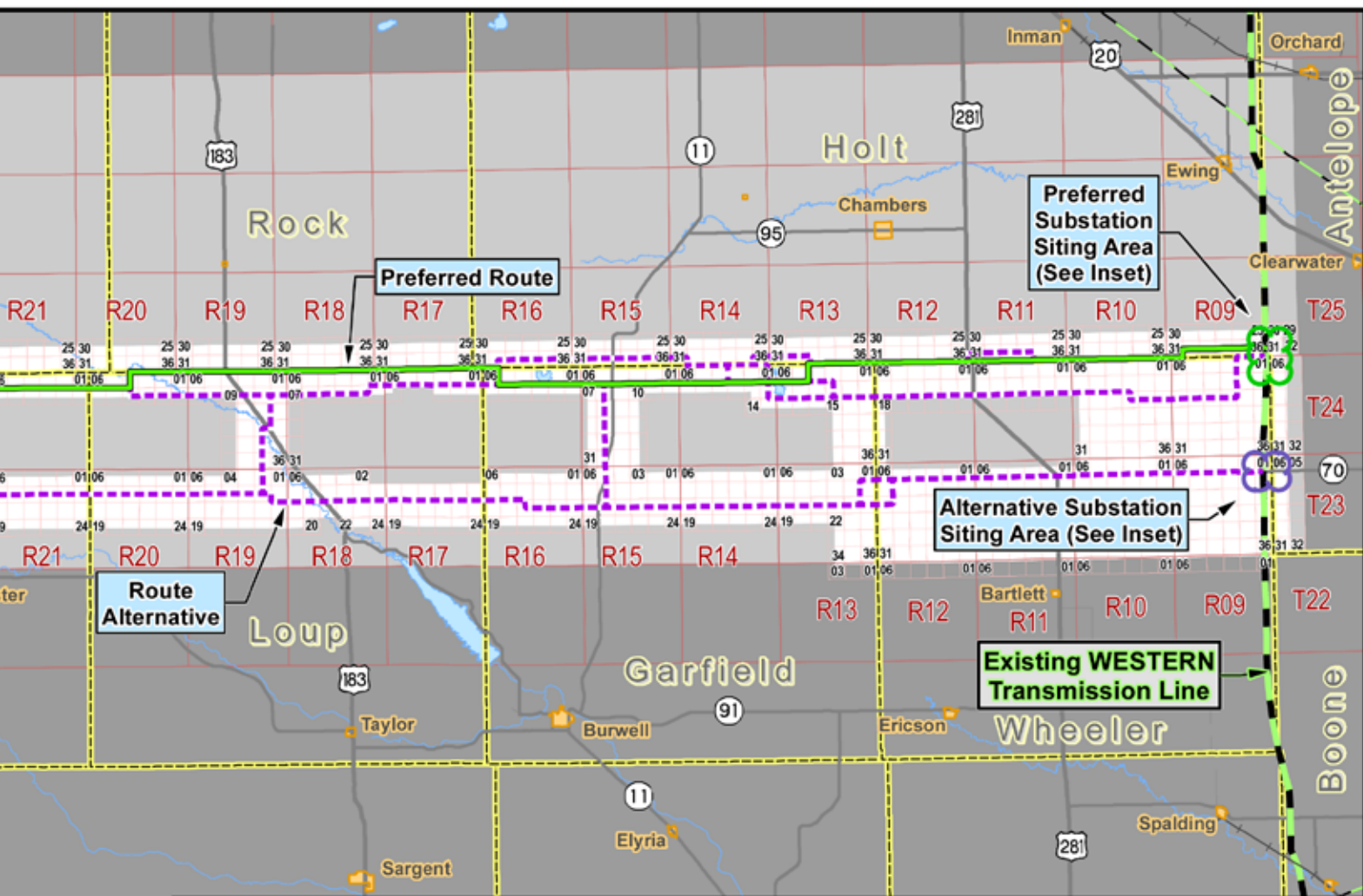

All landowners are encouraged to follow developments of the project through completion of the siting process. New information may require adjustments to the routes shown on this map. See website: <http://www.nppd.com/rproject>

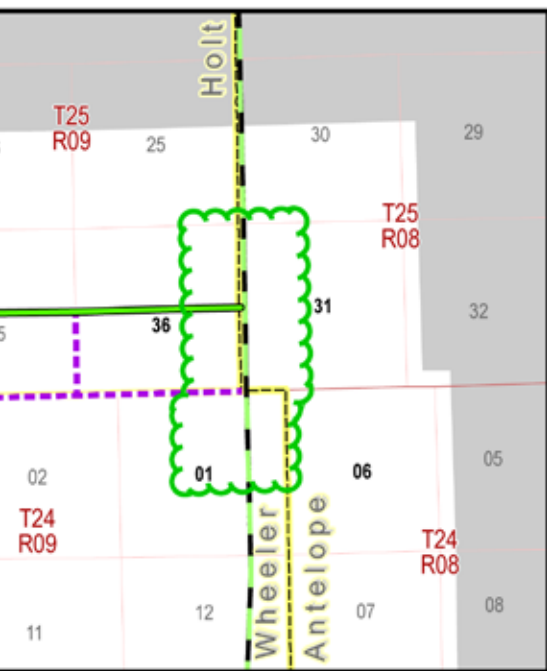

INSET

PREFERRED
Substation
Siting Area
Enlargement
ALTERNATIVE

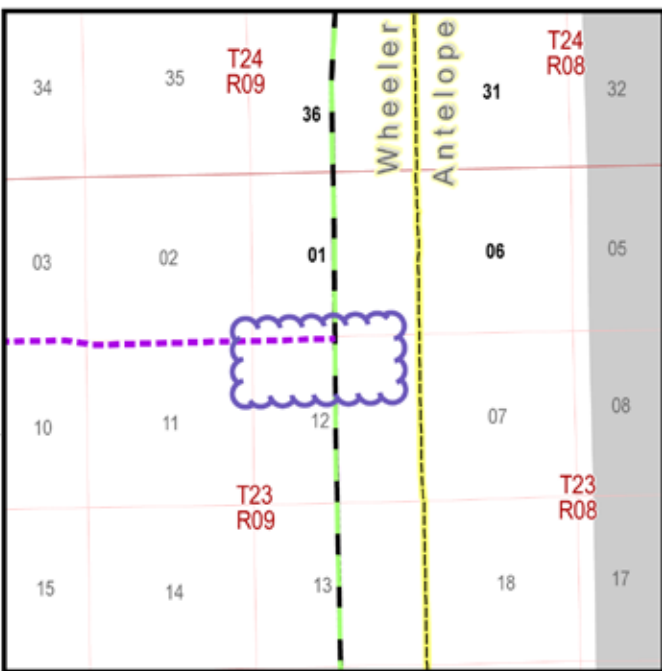

- Preferred Route
- Route Alternative
- Existing Transmission Line
- Section (Within or partially within Corridor)
- Corridor (white areas)
- City Limits
- County Boundary
- River
- Water body
- Township

NPPD's 345 kV Transmission Line Project
R - PROJECT
ROUTE ALTERNATIVES



Nebraska Public Power District
Always there when you need us

P.O. Box 499
 Columbus, NE 68602-0499

Address Service Requested

PRSR STD
 US POSTAGE
 PAID
 COLUMBUS NE
 PERMIT NO. 3

Attend an open house to learn more about the R-Project

All landowners within the original study area received this newsletter. Those with a potential route on their property also received an invitation letter to the open houses.

Conducting public hearings is the fourth and final step of NPPD's public involvement process. Public hearings for the R-Project are tentatively set for this fall/winter.

If you are unable to attend the public open house meetings, please visit the online open house meeting at www.nppd.com/rproject, available beginning April 29. Abbreviated information,

maps and drawings from the open house meeting will be available, as well as an opportunity for you to provide comments.

You may also share your feedback by emailing powerline@nppd.com or by calling the project hotline at 1-888-677-3412. All feedback will be taken into consideration before a final line route is chosen.



R-Project Open House Schedule

Tuesday, April 29

Logan County Fairgrounds
 71 Hwy 83, Stapleton, Neb.

Monday, May 5

Wheeler-Central High School
 (New Gym)
 214 5th Street, Bartlett, Neb.

Wednesday, April 30

Sutherland Public School
 (South Gym)
 401 Walnut Street, Sutherland, Neb.

Tuesday, May 6

Sandhills Public School (Gym)
 107 Gandy Avenue, Dunning, Neb.

Thursday, May 1

Thomas County Fairgrounds
 83861 Hwy 83, Thedford, Neb.

Wednesday, May 7

American Legion
 657 G Street, Burwell, Neb.

Please stop by between the hours of **2 p.m. and 8 p.m.** and allow 30-60 minutes to walk through the open house.

The R-Project 345 kV Transmission Line Newsletter is published by NPPD's transmission project team. It is intended to provide a project overview and communicate project developments.

Contributors: Project Manager **Craig Holthe**.
 Project Team: **Al Beiermann, Brenda Blatchford, Ross DeBower, Larry Linder, Tom Pillen, Dennis Schroeder, Ron Starzec** and **Terry Warth**.

Printing and artwork: **Bill Haack, Dan Zastera** and **Scott Margheim**.
 Editor: **Jill Novicki**

Contact us:
powerline@nppd.com

Mailing address:
R-Project 345 kV Transmission Line Project,
 NPPD, P.O. Box 499
 Columbus, NE 68602-0499
 Attention Jill Novicki
Phone (toll-free): 888-677-3412