



Nebraska Public Power District  
Always there when you need us

September 2014

R-Project 345,000 Volt



# Transmission Line PROJECT

## New routing options being considered

Nebraska Public Power District personnel are carefully studying the comments and information received on the R-Project, an approximate 220-mile 345,000 volt transmission line project that will run north from its Gerald Gentleman Station near Sutherland to a new substation to be sited adjacent to NPPD's existing substation east of Thedford. The new line will then proceed east and connect to a second substation to be sited in the Holt/Antelope/Wheeler County area. Comments have been received at the three open houses, as well as through emails, letters and phone calls.

New information gleaned from recent comments has caused NPPD officials to consider new routing options.

"Landowner feedback is a key component to finding a suitable line route with minimal impacts to landowners," said Senior Project Manager **Craig Holthe**. "Our maps are populated with information from various databases; however, that information is not always up-to-date, but it is a starting point. We hold the open houses so landowners can learn more about the project as well as provide input regarding their property and any future plans they may have. Landowner feedback can make a difference. For example, new information was provided that involved an existing air strip and additional land in the wetland reserve program."

Due to the new information, NPPD held two additional open houses in August that were targeted toward landowners on routes identified by blue lines within the black boxes as shown on the map inside this newsletter. "We started looking at additional routes in the areas of concern and realized that there was limited feedback from the landowners in those areas," explained Holthe. "The open houses were well attended and we gained some good information."

Holthe emphasized that no line route has been chosen at this time as NPPD continues to review feedback and study line route options.

### What's next?

After a proposed line route is chosen, a registered letter will be sent to each landowner along the route. The letter will include a map of the route and information on the public hearings. A public hearing will be held in each of the counties the transmission line crosses. NPPD plans to host public hearings later this year, followed by a 30-day comment period. After that, right-of-way agents will meet with landowners to obtain right-of-entry agreements so activities, such as surveying, can begin.

Landowners who are not along the proposed line route but who were in the original study area will receive a newsletter with a map of the proposed line route and information on the public hearings.

### Contact us!

Share your feedback with NPPD by emailing [powerline@nppd.com](mailto:powerline@nppd.com) or by calling the project hotline at 1-888-677-3412. All feedback will be taken into consideration before a final line route is chosen.

### On the map

Optional routes being considered are shown as blue lines on the map inside this newsletter. NPPD is considering alternative routes due to a variety of reasons such as:

- The need to eliminate conflict with an existing aviation operator south of Stapleton,
- The opportunity to reduce the number of residences located within 1/4 mile of the transmission line in the area east of Thedford,
- The discovery of additional wetland reserve program lands were noted in the area east and west of Highway 183.

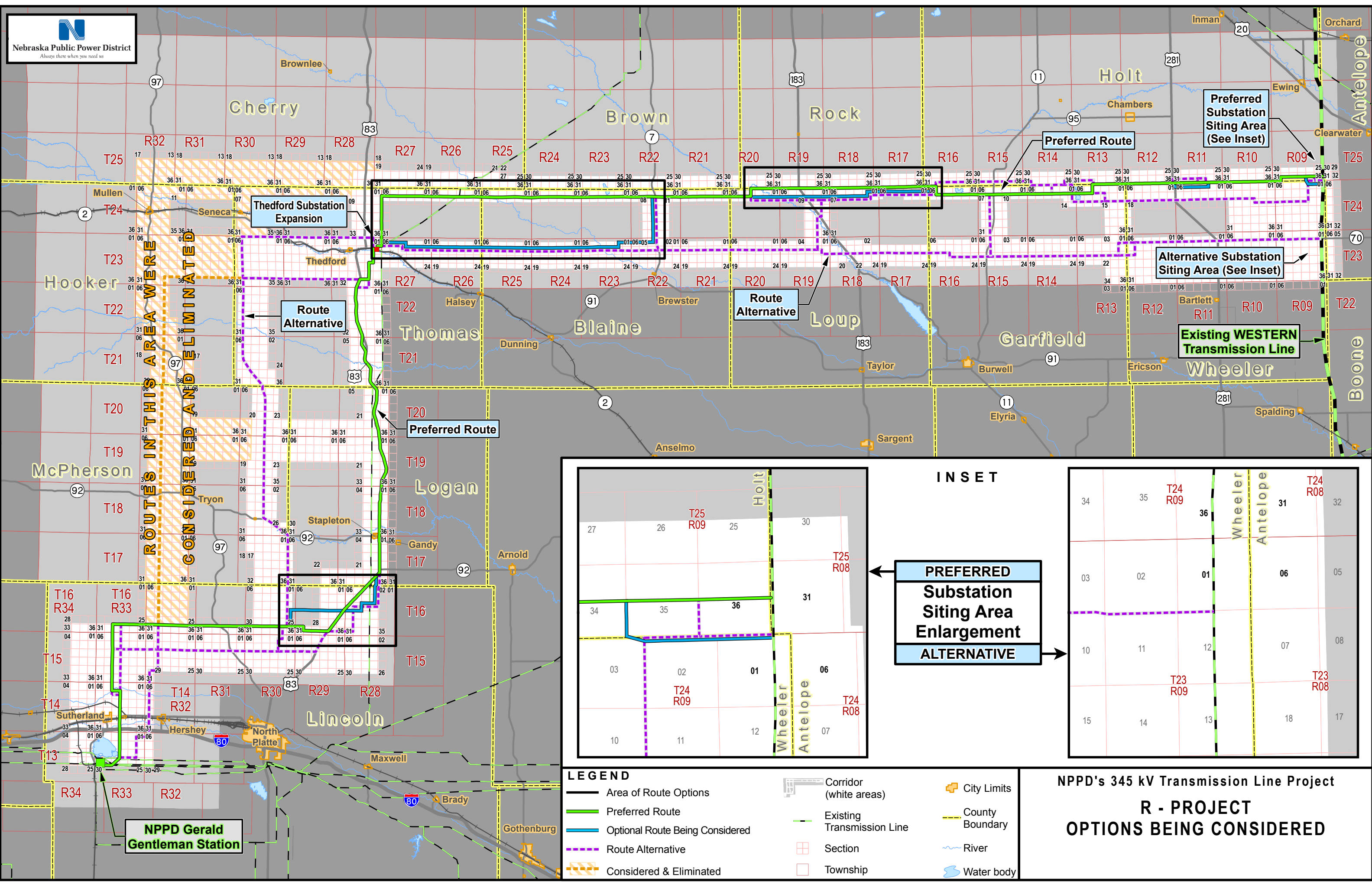

**ROUTES IN THIS AREA WERE CONSIDERED AND ELIMINATED**

**NPPD Gerald Gentleman Station**

**Thedford Substation Expansion**

**Route Alternative**

**Preferred Route**

**Route Alternative**

**Preferred Route**

**Preferred Substation Siting Area (See Inset)**

**Alternative Substation Siting Area (See Inset)**

**Existing WESTERN Transmission Line**

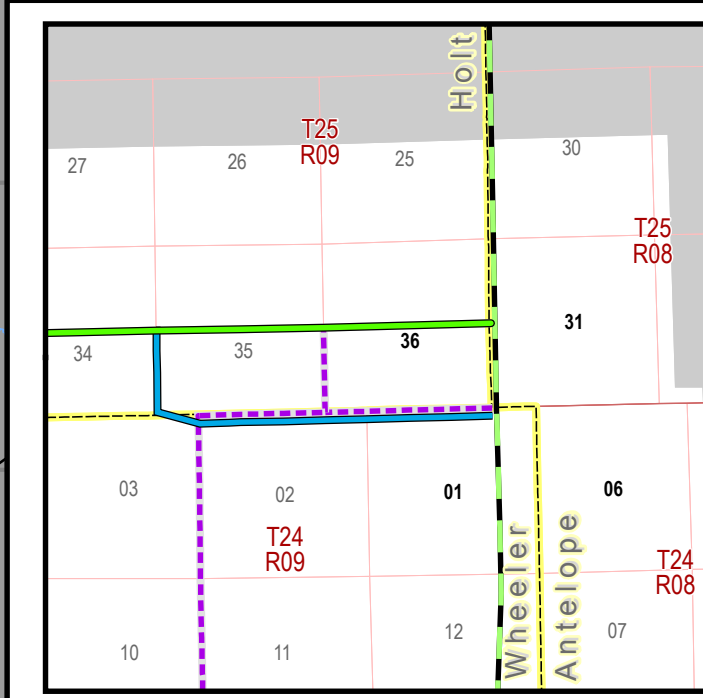

**PREFERRED Substation Siting Area Enlargement ALTERNATIVE**

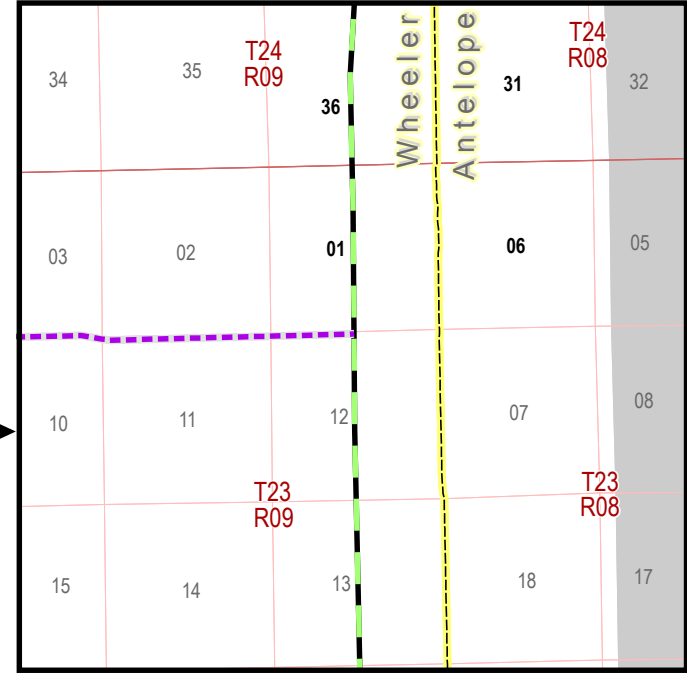

- LEGEND**
- Area of Route Options
  - Preferred Route
  - Optional Route Being Considered
  - Route Alternative
  - Considered & Eliminated
  - Corridor (white areas)
  - Existing Transmission Line
  - Section
  - Township
  - City Limits
  - County Boundary
  - River
  - Water body

**NPPD's 345 kV Transmission Line Project**  
**R - PROJECT**  
**OPTIONS BEING CONSIDERED**



**Nebraska Public Power District**  
Always there when you need us

P.O. Box 499  
Columbus, NE 68602-0499

Address Service Requested

PRSRT STD  
US POSTAGE  
PAID  
COLUMBUS NE  
PERMIT NO. 3

## The Southwest Power Pool, NPPD's Regional Transmission Organization, conducted studies that show three main benefits of the R-Project.

**Enhance reliability** – All Nebraskans will benefit from the R-Project. Senior Project Manager **Craig Holthe** noted that the electrical grid will be less vulnerable to disruptions by having another power line in place. “By adding this line and separating it from existing lines, our transmission system will be in a stronger position to maintain electric service to customers during storms and other challenges to the system.” Past history of ice storms across Nebraska shows the value this line can provide in continuing service to customers while other lines may be damaged.

**Relieve congestion** – “Electricity usage has grown significantly over the years” explained Holthe. “As our energy demands continue to grow, we need our infrastructure to grow with it to keep up with those demands.” The R-Project will provide an additional avenue for power to get to where it is needed, thereby reducing congestion on other transmission lines and providing more efficient use of the entire electric system, including maximizing the use of the most efficient generation facilities connected to NPPD’s system. “This efficiency in operation will help NPPD and your electric utility deliver to you the lowest priced energy available on the system,” said Holthe.

**Renewable generation opportunities** – Studies indicate the area considered for the transmission line project contains quality wind resource potential. This project will provide access to the transmission system for wind projects by electric utilities if they are determined necessary in the future, as well as access for projects that may be pursued by private developers. At this time, no specific wind projects have been identified.

**Stay connected.  
Follow us online.**

**The R-Project 345 kV Transmission Line Newsletter** is published by NPPD’s transmission project team. It is intended to provide a project overview and communicate project developments.

Contributors: Project Manager **Craig Holthe**.  
Project Team: **Al Beiermann, Brenda Blatchford, Ross DeBower, Larry Linder, Tom Pillen, Dennis Schroeder, Ron Starzec** and **Terry Warth**.

Printing and artwork: **Bill Haack, Dan Zastera** and **Scott Margheim**.  
Editor: **Jill Novicki**

**Contact us:**  
powerline@nppd.com

**Mailing address:**  
*R-Project 345 kV Transmission Line Project*,  
NPPD, P.O. Box 499  
Columbus, NE 68602-0499  
Attention Jill Novicki

**Phone (toll-free):** 888-677-3412  
**Website:** www.nppd.com/rproject